

**TYPE: ME.TRU-4 4VA**  
**CORE SIZE: UI30/7,5**

**Features**

- Epoxy resin cast
- Two chambers bobbin
- Insulation primary-secondary: 4KV.
- Increased humidity resistance

**Manufacturing standard EN 61558**

- Safety insulation transformer
- Max.ambient temperature:  $t_a 70^{\circ}\text{C}$
- Insulation class:  $t_a 70^{\circ}/ B 130^{\circ}\text{C}$
- Degree of protection: IP00
- Not short-circuited

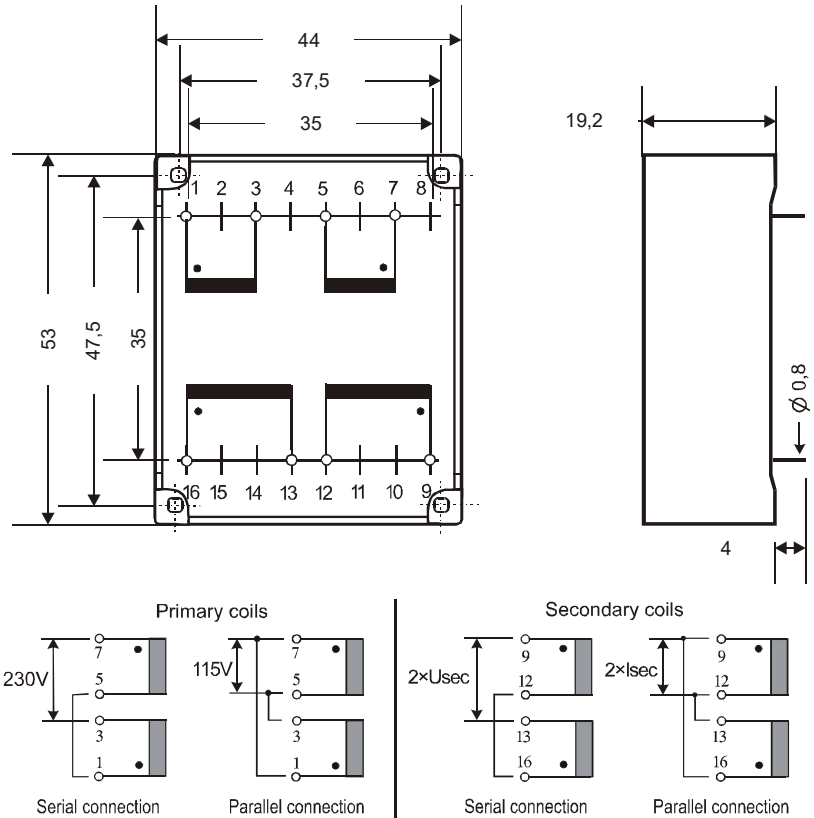

- The mains voltage may be 10% higher or lower than the nominal one so the power of the transformer has to be chosen accordingly.
  - The tests of transformers according to the standard EN61558-1 chapter 27.2 were not carried out because the final design of the cover can affect the result. The chapter 27.2 does not concern to the IP00 protection.
  - The threshold temperature at abnormal operating conditions is the temperature which has to be taken into consideration if the transformer is built in a device.
- Non-inherently short-circuit proof transformer in case of insulation class "B": 225 °C

**Application**

- PCB mounting installation
- Low height design
- Possibility of serial and parallel connection of primary and secondary coils

*Deviation of secondary voltages 5%*

*Prescribed primary circuit fuse 32mA T*

Modell number	Primary voltage	Pin configuration	Secondary voltage	Pin configuration	Secondary current
ME.TRU-4.30206-2	2×115 V	1-3 5-7	2×6 V	9-12 13-16	2×0,33 A
ME.TRU-4.30275-2	2×115 V	1-3 5-7	2×7,5 V	9-12 13-16	2×0,26 A
ME.TRU-4.30209-2	2×115 V	1-3 5-7	2×9 V	9-12 13-16	2×0,22 A
ME.TRU-4.30212-2	2×115 V	1-3 5-7	2×12 V	9-12 13-16	2×0,16 A
ME.TRU-4.302135-2	2×115 V	1-3 5-7	2×13,5 V	9-12 13-16	2×0,14 A
ME.TRU-4.30215-2	2×115 V	1-3 5-7	2×15 V	9-12 13-16	2×0,13 A
ME.TRU-4.30218-2	2×115 V	1-3 5-7	2×18 V	9-12 13-16	2×0,11 A
ME.TRU-4.30224-2 *	2×115 V	1-3 5-7	2×24 V	9-12 13-16	2×0,08 A

\*Certified as insulation transformer